

AUDITOR RSB-250

Subwoofer (10")



- Polypropylene cone
- Steel basket
- 4 Ω dual voice coil

SPECIFICATIONS

Nominal power	250W RMS	
Maximum power	500W	
Sensitivity (2,83V/1m)	88dB	
Cone type	Polypropylene	
Surround type	Butyl	
Nom. impedance	4Ω + 4Ω	
DC resistance	3.2Ω + 3.2Ω	
VC diameter	50mm	2S"
Net weight	3400g	7.50lbs

FREQUENCY RESPONSE/IMPEDANCE

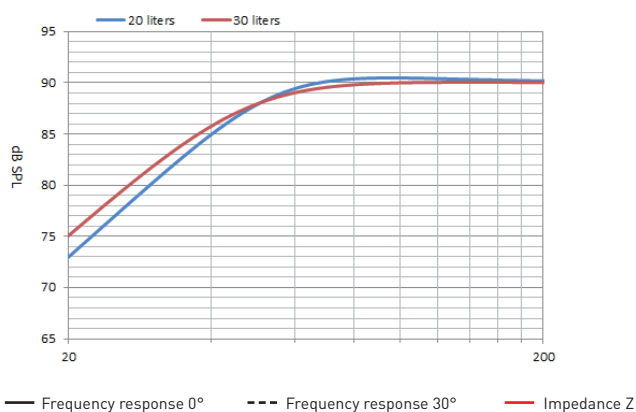

PARAMETERS

Fs	29Hz
Vas	42l
Qts	0.59
Qes	0.68
Qms	4.7
Re	3.2Ω + 3.2Ω
Sd	307cm ²
Cms	0.3mm/N
Mms	93g
Bl	6.7 N/A

MECHANICAL DRAWING

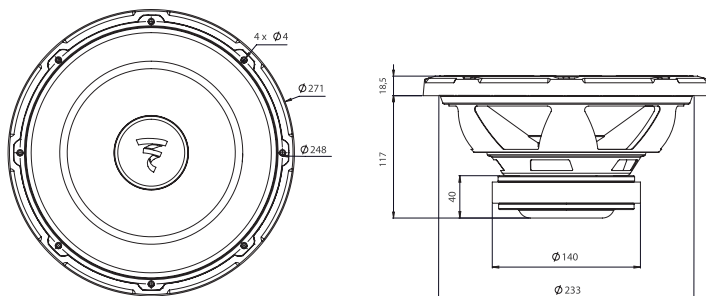

Performance
CREATE YOUR SOUND

FOCAL